

DWG NO. -

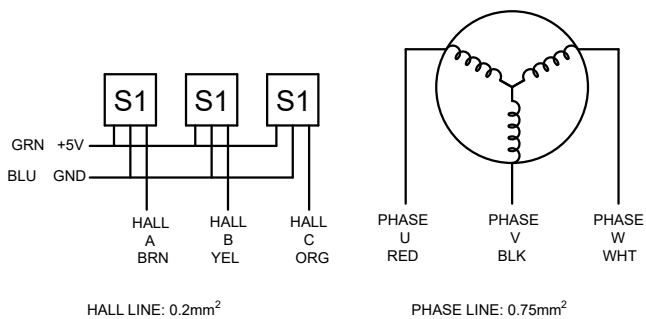
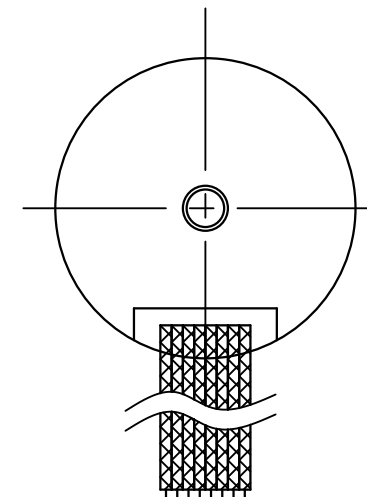
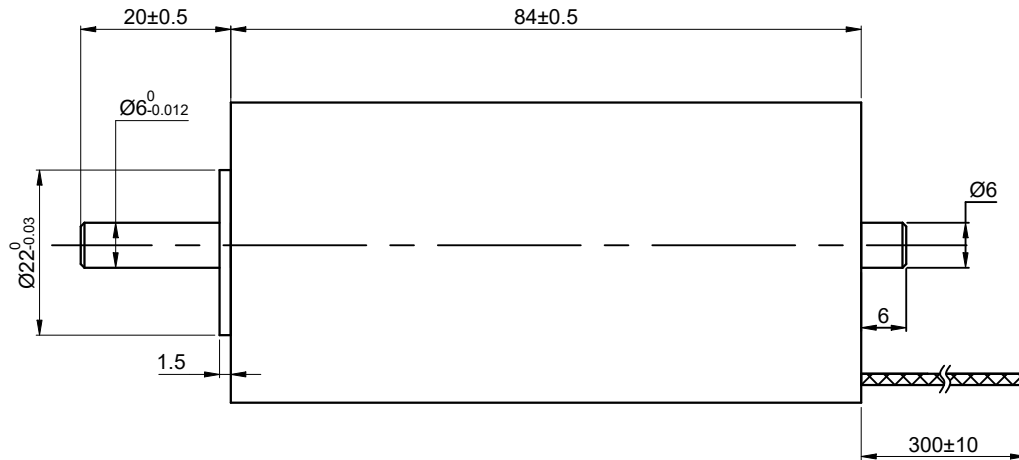
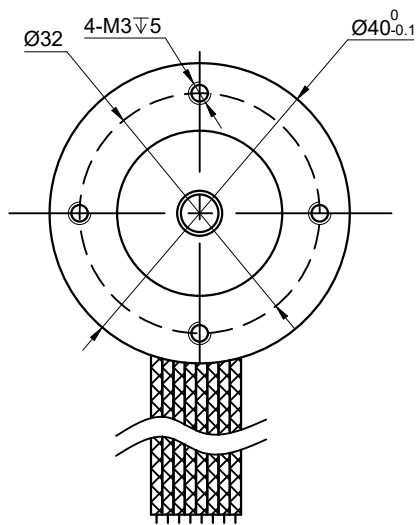

| SPECIFICATION                | VALUE    |
|------------------------------|----------|
| RATED VOLTAGE(V)             | 310      |
| TERMINAL RESISTANCE(Ohms)    | 1.8      |
| TERMINAL INDUCTANCE(mH)      | 0.48     |
| NO LOAD SPEED(RPM)           | 15000    |
| NO LOAD CURRENT(A)           | 0.7      |
| RATED SPEED(RPM)             | 11000    |
| RATED CURRENT(A)             | 1.32     |
| RATED TORQUE(mNm)            | 260      |
| RATED POWER(W)               | 299.48   |
| THE GREATEST POWER OUTPUT(W) | 13238.94 |
| EFFICIENCY(%)                | 87.66    |
| TORQUE CONSTANT(mNm/A)       | 196.55   |
| STALL TORQUE (mNm)           | 33712.69 |
| BACK-EMF CONSTANT(mV/RPM)    | 20.58    |
| SPEED CONSTANT(RPM/V)        | 48.58    |
| FRICITION TORQUE(mNm)        | 137.58   |
| CURRENT CONSTANT(A/mNm)      | 0.01     |

UNIT mm  
GB/T 1804-M EQV.ISO 2768-1 CLASS M:

|          |      |
|----------|------|
| <=6      | ±0.1 |
| >6~30    | ±0.2 |
| >30~120  | ±0.3 |
| >120~400 | ±0.5 |

**OSMTEC**®  
Stepper Motor Specialists

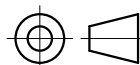

|       |           |      |           |
|-------|-----------|------|-----------|
| mm    |           |      |           |
| UNITS | DRN       | MYX  | 1.13.2026 |
| 3:2   | APVD      | LDJ  | 1.13.2026 |
| SCALE | SIGNATURE | DATE |           |

**BRUSHLESS DC MOTOR**

**40CL84-310-P2-11000**