

DWG NO. -

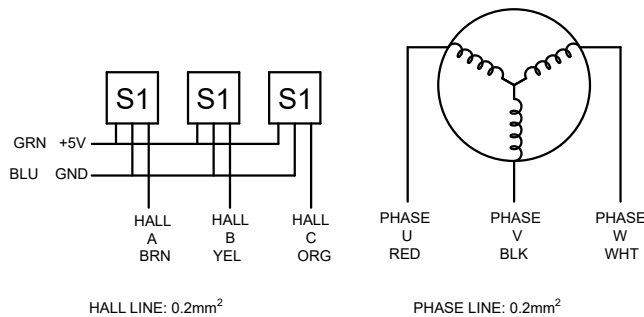

SPECIFICATION	VALUE
RATED VOLTAGE(V)	18
TERMINAL RESISTANCE(Ohms)	0.12
TERMINAL INDUCTANCE(mH)	0.008
NO LOAD SPEED(RPM)	57700
NO LOAD CURRENT(A)	0.7
RATED SPEED(RPM)	54500
RATED CURRENT(A)	5.40
RATED TORQUE(mNm)	16
RATED POWER(W)	91.31
THE GREATEST POWER OUTPUT(W)	668.71
EFFICIENCY(%)	86.80
TORQUE CONSTANT(mNm/A)	2.97
STALL TORQUE(mNm)	442.69
BACK-EMF CONSTANT(mV/RPM)	0.31
SPEED CONSTANT(RPM/V)	3220.58
FRICITION TORQUE(mNm)	2.08
CURRENT CONSTANT(A/mNm)	0.34

UNIT mm
 GB/T 1804-M EQV.ISO 2768-1 CLASS M:
 <=6 ±0.1
 >6~30 ±0.2
 >30~120 ±0.3
 >120~400 ±0.5

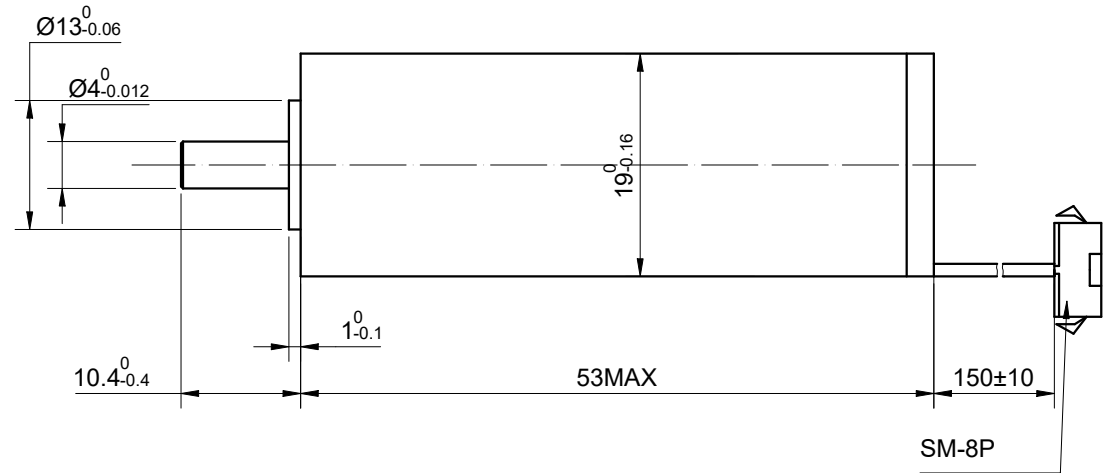
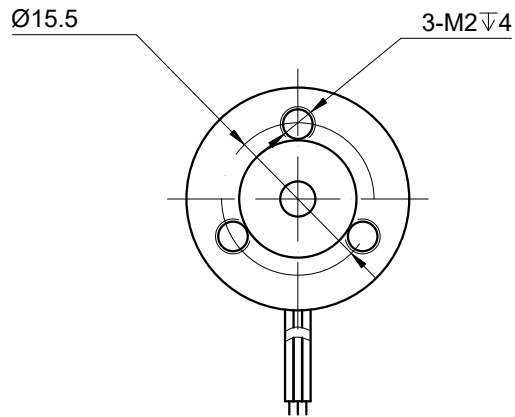
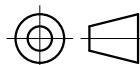

mm			
UNITS	DRN	MYX	1.13.2026
3:2	APVD	LDJ	1.13.2026
SCALE	SIGNATURE	DATE	

BRUSHLESS DC MOTOR

19CL54-18-P2-54500

OSMTEC®
 Stepper Motor Specialists