

FULL STEP 2 PHASE-Ex., WHEN FACING MOUNTING END (X)

STEP	A+	B+	A-	B-		CCW
1	+	+	-	-		↑
2	-	+	+	-		↓
3	-	-	+	+		
4	+	-	-	+		

UNIT mm  
 GB/T 1804-M EQV.ISO  
 2768-1 CLASS M:  
 <=6 ±0.1  
 >6~30 ±0.2  
 >30~120 ±0.3  
 >120~400 ±0.5

WINDING			CONNECTION		SPECIFICATION		BIPOLAR	
			AMPS/PHASE		0.40		0.40	
			RESISTANCE/PHASE(Ohms)@25°C		30.00±10%		30.00±10%	
			INDUCTANCE/PHASE(mH)@1KHz		37.00±20%		37.00±20%	
			HOLDING TORQUE(Nm)[lb-in]		0.26[2.30]		0.26[2.30]	
			STEP ANGLE(°)		1.80		1.80	
			STEP ACCURACY(NON-ACCUM)		±5.00%		±5.00%	
PIN NO	BIPOLAR	LEADS	LEAD(mm)		2			
1	A+	RED	LINEAR TRAVEL/STEP(mm)		0.01			
2	A-	GRY	AMBIENT TEMPERATURE		-10°C~50°C[14°F~122°F]			
3	B+	YEL	INSULATION CLASS		B 130°C[266°F]			
4	B-	GRN	TEMPERATURE RISE		MAX.80°C			

**OSMTEC**®  
 Stepper Motor Specialists

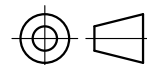

mm			
UNITS	DRN	MYX	1.9.2026
1:1	APVD	LDJ	1.9.2026
SCALE	SIGNATURE	DATE	

**LINEAR STEPPER MOTOR**

**17N13S0404AF4-150RS**