

DWG NO. -

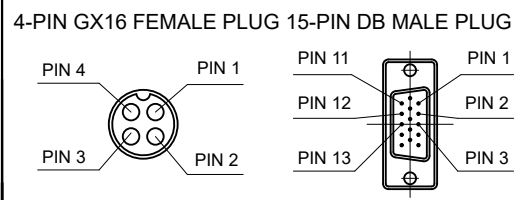

BRAKE CONNECTIONS

24V 0.5N.m

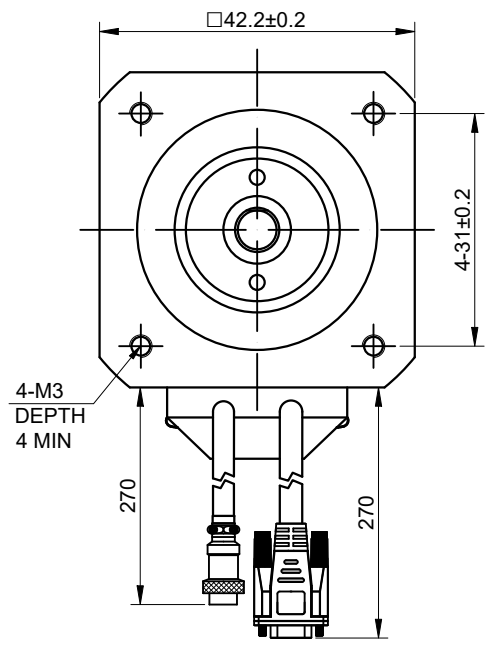
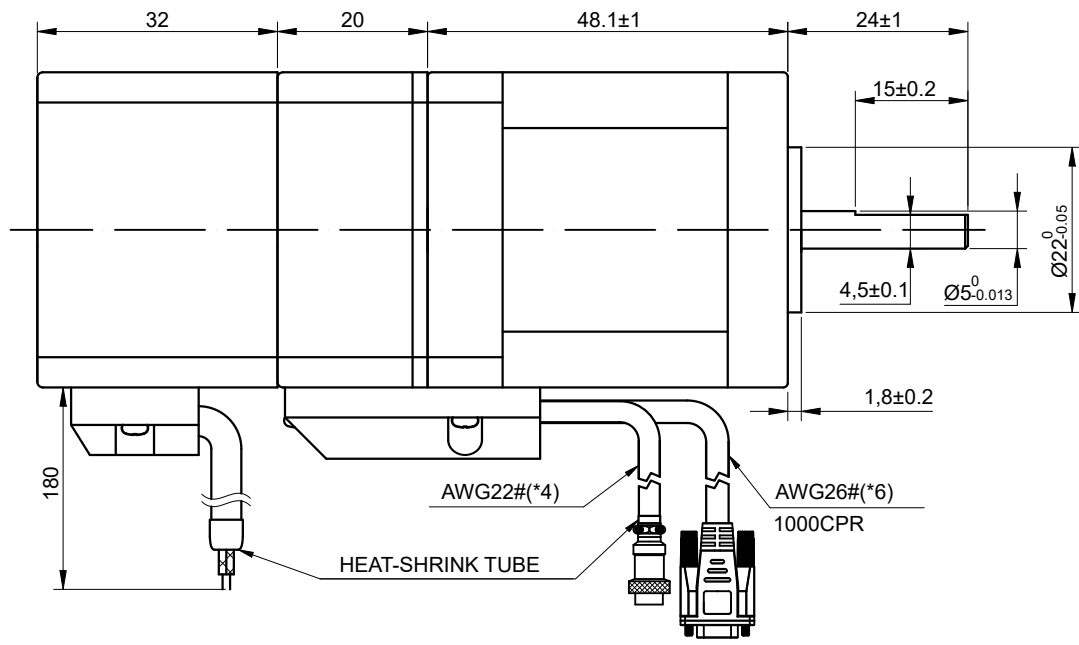
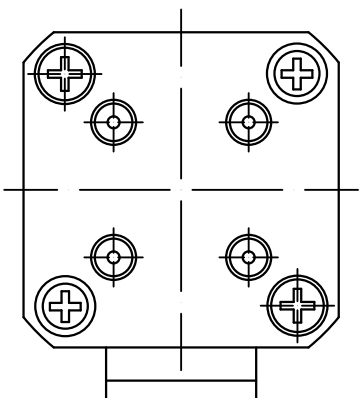
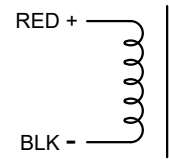

15-PIN DB MALE PLUG	1	2	3	11	12	13
DESCRIPTION	EA+	VCC	GND	EB+	EB-	EA-

FULL STEP 2 PHASE-Ex., WHEN FACING MOUNTING END (X)

STEP	A+	B+	A-	B-		CCW
1	+	+	-	-	 CW	
2	-	+	+	-		
3	-	-	+	+		
4	+	-	-	+		

UNIT mm
 GB/T 1804-M EQV.ISO
 2768-1 CLASS M:
 <=6 ±0.1
 >6~30 ±0.2
 >30~120 ±0.3
 >120~400 ±0.5

WINDING			SPECIFICATION	CONNECTION	BIPOLAR
			AMPS/PHASE		2.00
			RESISTANCE/PHASE(Ohms)@25°C		1.35±10%
			INDUCTANCE/PHASE(mH)@1KHz		2.80±20%
			HOLDING TORQUE(Nm)[lb-in]		0.48 [4.25]
			STEP ANGLE(°)		1.80
			STEP ACCURACY(NON-ACCUM)		±5.00%
PIN NO	BIPOLAR	LEADS	ROTOR INERTIA(g-cm ²)		77
1	A+	--	WEIGHT(Kg)[lb]		—
2	A-	--	AMBIENT TEMPERATURE		-10°C~50°C[14°F~122°F]
3	B+	--	INSULATION CLASS		B 130°C[266°F]
4	B-	--	TEMPERATURE RISE		MAX.80°C

OSMTEC®
 Stepper Motor Specialists

mm			
UNITS	DRN	ZPJ	1.16.2026
1:1	APVD	YSX	1.16.2026
SCALE	SIGNATURE	DATE	

STEPPER MOTOR
 17E1KBK05-05