

DWG NO. -

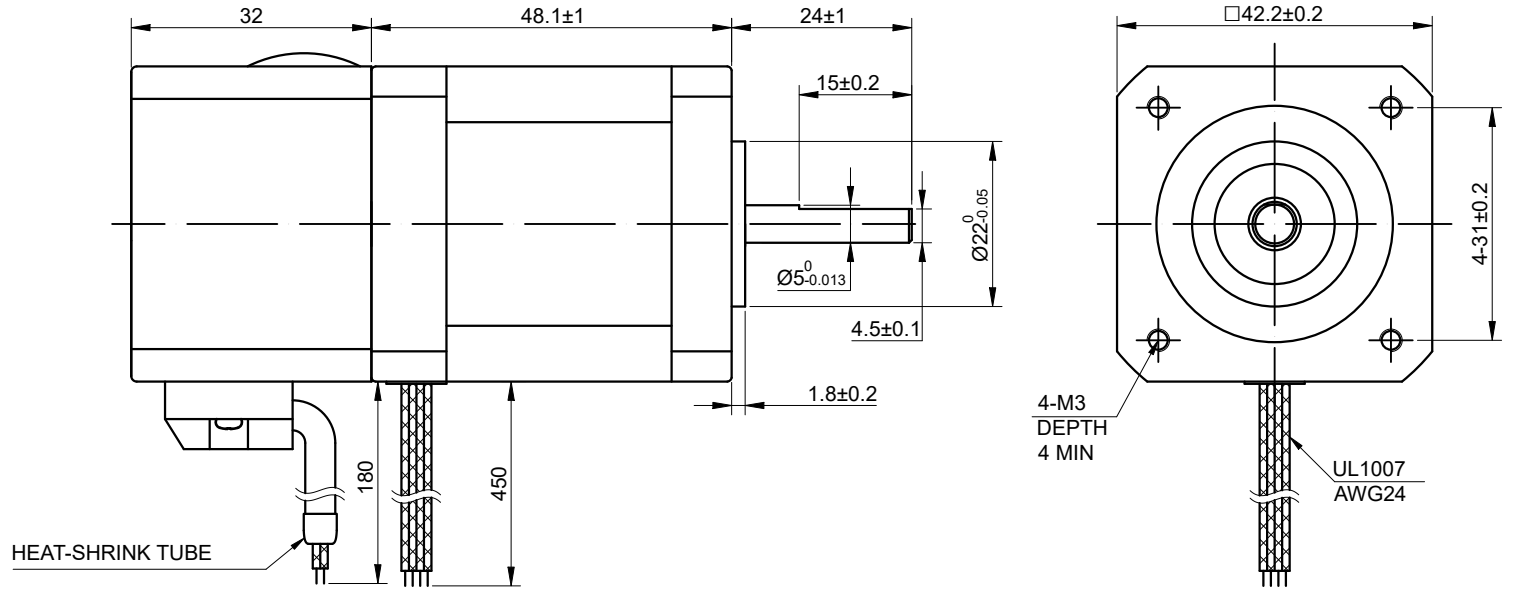

BRAKE CONNECTIONS

24V 0.5N.m

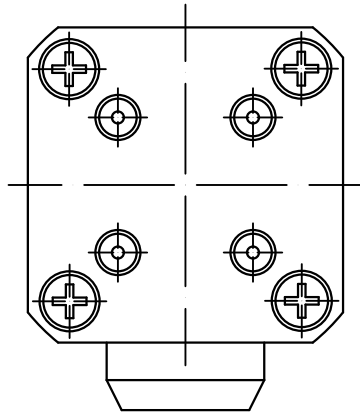
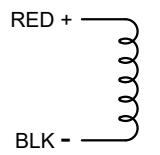

FULL STEP 2 PHASE-Ex., WHEN FACING MOUNTING END (X)

| STEP | A+ | B+ | A- | B- | | CCW |
|------|----|----|----|----|--------------|-----|
| 1 | + | + | - | - | ↓ ↑ CW | ↑ |
| 2 | - | + | + | - | | |
| 3 | - | - | + | + | | |
| 4 | + | - | - | + | | |

UNIT mm
GB/T 1804-M EQV.ISO
2768-1 CLASS M:
≤6 ±0.1
>6~30 ±0.2
>30~120 ±0.3
>120~400 ±0.5

| WINDING | | | CONNECTION | BIPOLAR |
|---------|---------|-------|-----------------------------------|------------------------|
| | | | SPECIFICATION | |
| | | | AMPS/PHASE | 2.00 |
| | | | RESISTANCE/PHASE(Ohms)@25°C | 1.35±10% |
| | | | INDUCTANCE/PHASE(mH)@1KHz | 2.80±20% |
| | | | HOLDING TORQUE(Nm)[lb-in] | 0.48 [4.25] |
| | | | STEP ANGLE(°) | 1.80 |
| PIN NO | BIPOLAR | LEADS | ROTOR INERTIA(g-cm ²) | 77 |
| 1 | A+ | BLK | WEIGHT(Kg)[lb] | — |
| 2 | A- | GRN | AMBIENT TEMPERATURE | -10°C~50°C[14°F~122°F] |
| 3 | B+ | RED | INSULATION CLASS | B 130°C[266°F] |
| 4 | B- | BLU | TEMPERATURE RISE | MAX.80°C |

OSMTEC®
Stepper Motor Specialists

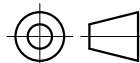

mm

UNITS

1:1

SCALE

DRN

APVD

SIGNATURE

ZPJ

YSX

DATE

1.16.2026

1.16.2026

DATE

STEPPER MOTOR

17BK05-05